



GLASS DOOR BACKBAR REFRIGERATORS

CONTACT US:

Customer Service:
+1 (786) 5847439

Sales Team:
+1 (786) 8602528

Email:
sales@lfsusa.store

www.lfsusa.store

COMPETITOR SERIES®

C-BB48G-HC

C-BB60G-HC

C-BB72G-HC

GLASS DOOR BACK BAR REFRIGERATORS

- Beautiful ergonomic construction
- Black corrosion resistant steel exterior, stainless steel interior and stainless steel top
- Digital temperature controller and read-out
- Forced air refrigeration system
- Side mount compressor
- Safety-grip door handles
- LED interior lighting
- Door locks
- Leveling feet included
- Accessory: optional casters upon request
- All Natural R290 Hydrocarbon Refrigerant
- US Department of Energy Certified
- Migali® Protection Plan: 2 Year Parts & Labor Warranty, 5 Years Compressor Warranty

| MODEL | DOORS | CAPACITY CU/FT | STORAGE CAPACITY | SHELVES | H/P | AMPS | VOLTAGE | PLUG TYPE | TEMP RANGE | EXTERIOR DIMENSIONS W X D X H | INTERIOR DIMENSIONS W X D X H | PACKAGED DIMENSIONS W X D X H | WEIGHT | PACKAGED WEIGHT |
|------------|-------|----------------|--|---------|-----|------|----------|------------|----------------------|-------------------------------|-------------------------------|-------------------------------|----------|-----------------|
| C-BB48G-HC | 2 | 13 | 546 (12 oz.) cans 336 (12 oz.) bottles 2 (1/2 barrel) kegs | 4 | 1/5 | 2.8 | 115/60/1 | Nema 5-15P | +33° F (-) +38° F | 48.75 x 24.5 x 35.7 | 36.25 x 18.25 x 30.5 | 51.25 x 27.5 x 41.75 | 231 lbs. | 282 lbs. |
| C-BB60G-HC | 2 | 17.3 | 756 (12 oz.) cans 456 (12 oz.) bottles 2 (1/2 barrel) kegs | 4 | 1/5 | 2.8 | 115/60/1 | Nema 5-15P | +33° F (-) +38° F | 60.75 x 25.75 x 35.7 | 48.25 x 18.5 x 28.9 | 63.5 x 27.5 x 41.75 | 276 lbs. | 319 lbs. |
| C-BB72G-HC | 3 | 21.6 | 966 (12 oz.) cans 576 (12 oz.) bottles 3 (1/2 barrel) kegs | 6 | 1/4 | 3.96 | 115/60/1 | Nema 5-15P | +33° F (-) +38° F | 72.75 x 24.5 x 35.7 | 60.2 x 18.5 x 30.5 | 75.25 x 27.5 x 41.75 | 331 lbs. | 374 lbs. |

Accessories:

- Caster - stem - with brake (5-3/4" overall) - Part Number 1597-01
- Caster - plate - with brake (5-1/4" overall) - Part Number 2481-329

FOR COMMERCIAL USE ONLY
NOTE: MIGALI® RESERVES THE RIGHT TO CHANGE SPECIFICATIONS WITHOUT NOTICE

TOLL FREE: 800.852.5292
WEB: www.migali.com

DIMENSIONAL DRAWINGS

C-BB48G-HC

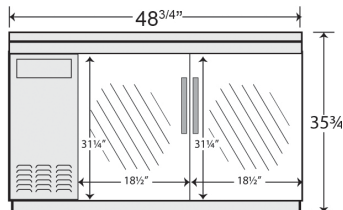

C-BB60G-HC

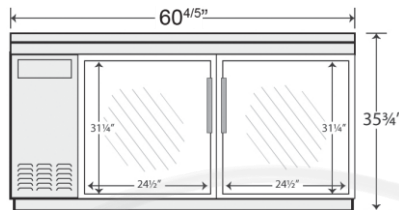

C-BB72G-HC

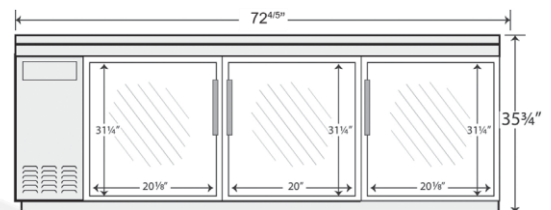

**C-BB48G-HC
TOP VIEW**



**C-BB60G-HC
TOP VIEW**

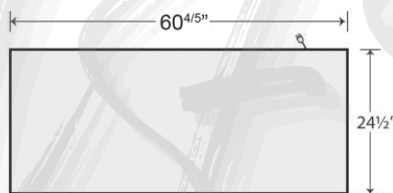

**C-BB72G-HC
TOP VIEW**

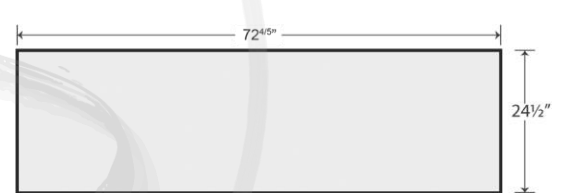

Latam Food Service

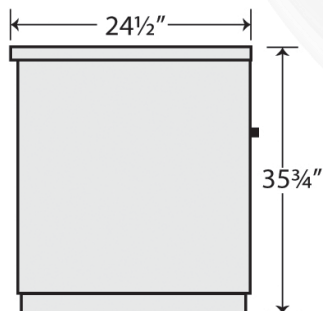

SIDE VIEW (1,2,3) DOOR MODELS



MIGALI® REMAINS AN AMERICAN FAMILY COMPANY SINCE 1955