



## MEGA TOP SANDWICH PREP REFRIGERATOR

CONTACT US:

**Customer Service:**  
+1 (786) 5847439

**Sales Team:**  
+1 (786) 8602528

**Email:**  
sales@lfsusa.store

[www.lfsusa.store](http://www.lfsusa.store)

# About us



LFSUSA.STORE is a company specialized in the commercialization of equipment for restaurants, in addition to being representatives of manufacturers to the food industry. Our clients can experience the quality of our personalized service. Contact us and receive the necessary support so that the purchase of your food equipment is a wise investment.

We're more than just an online retailer. Since 2015, we've created an innovative, easy-to-use website to meet the purchasing needs of businesses from all over the globe. LFSUSA.STORE, The Leading Distributor of Restaurant Supplies and Equipment

We have everything your business needs to function at its best. Over the years we have expanded our selection of commercial equipment and wholesale supplies to include healthcare, educational, food, beverage, office, parts, hotel, shipping, and industrial supplies. Our focus is your convenience – order online from your laptop, desktop, or smartphone 24 hours a day, 7 days a week. Our fast shipping, low prices, and outstanding customer service make Latam Food Service the best choice to meet all of your professional and food service supply needs.



## Amazing Customer Service

Our personalized customer service helps you buy what you need without mistakes!



## No Hiddern Costs!

The prices you see on the site are the ones you pay for the equipment! No extra charges at delivery!



## Free Shipping on All Orders

Get free shipping on all orders within the US and they'll arrive in 5-8 calendar days!



## High Quality Content

We provide you with the relevant info you need to make the right purchasing decisions. Every one of our product descriptions is written by a dedicated content writer.

# MEGA TOP SANDWICH PREP REFRIGERATOR

## Key features:

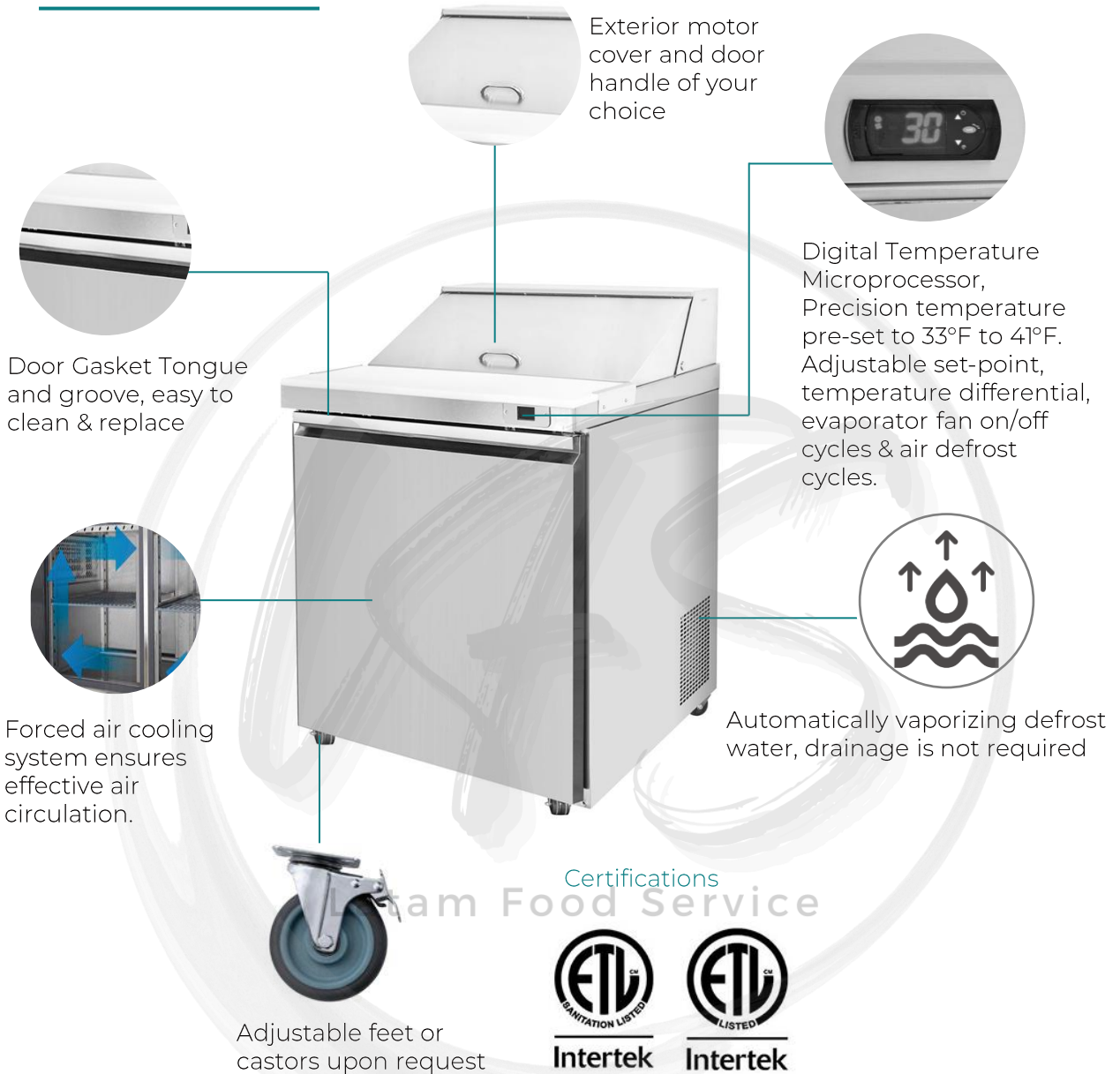

Atlas Air's Mega Top Sandwich Prep Table Refrigerators are an excellent choice for preparing sandwiches, salads and cold food products in your restaurant or commercial kitchen. With a stainless steel exterior, bright white interior, forced air refrigeration system and digital thermostat microprocessor, your food products are sure to maintain consistent temperatures of 33°F to 41°F in the bottom storage area as well as the top pan rail even in the busiest kitchens.

# MEGA TOP SANDWICH PREP TABLE REFRIGERATORS

## TECHNICAL DATA



Model Numbers		ASP29M	ASP48M
<b>Dimensions &amp; Construction</b>	Interior Capacity (cu/ft)	6.7	13.8
	GN Pans	12, Clear Plastic	18, Clear Plastic
	Exterior Size WxDxH (inches)	29 x37 1/4x47 7/8	48 3/8 x 37 1/4x47 7/8
	Interior Size WxDxH (inches)	24 3/4 x 25 3/8 x 28 3/4	44 1/4 x 25 3/8 x 28 3/4
	Exterior Construction	High polished stainless steel	
	Interior Construction	Bright white powder coated aluminum	
	Cutting Board WxDxH (inches)	29 x 9 1/2 x 1, NSF certified polyethylene white plastic	48 3/8 x 9 1/2 x 1, NSF certified polyethylene white plastic
	Shelves	1 white epoxy coated wire	2 white epoxy coated wire
	Handle	ABS Plastic, recessed	
	Solid Door	1 Stainless Steel Door	2 Stainless Steel Doors
	Door Gasket	Tongue and groove, easy to clean & replace	
	Hinges	Stainless steel	
	Pilasters and Shelf Clips	Stainless steel	
	<b>Refrigeration System</b>	Floor	Rounded, coved corners
Casters		(2) Locking, (2) non-locking	
Temperature Range		33°F to 41°F	33°F to 41°F
Refrigeration System		Forced Air	
Refrigerant		R290	R291
Expansion Device		Capillary Tube	
Defrost method		Automatic	
Compressor Type		Hermetic compressor	
<b>Electrical System</b>	Condenser Type	Air cooled, electrostatic coated copper tube	
	Evaporator Type	Air cooled, electrostatic coated copper tube	
	Humidity control	Hot gas condensation evaporation	
	Power	115/60/1	115/60/1
	Plug	8 Ft NEMA 5-15P	8 Ft NEMA 5-15P
<b>Packaging &amp; Shipping Info</b>	Horse Power	1/6	1/5
	Kilowatts per 24 Hours		
	Amperage	2.8	3.9
	Shipping Dimensions		
	Shipping Weight		
<b>Digital Temperature Controller</b>	Palletized	Yes, wood, front/back loading	
	Material	Wood, card board, styrofoam, plastic wrap	
	UPC GTIN		
	Digital Temperature Microprocessor	Precision temperature pre-set to 33°F to 41°F. Adjustable set-point, temperature differential, evaporator fan on/off cycles & air defrost cycles.	
	Key Pad	Adjustable, tactile key pad	
<b>Warranty</b>	Screen	2" blue LCD	2" blue LCD
	Water resistant	Yes	Yes
	Compressor	5 Years	5 Years
<b>Certifications</b>	Parts	2 Years	2 Years
	Labor	2 Year	2 Year
<b>Application</b>	ETL sanitation (conforms to NSF 7 Foodservice), ETL electrical (US and Canada)		
<b>Application</b>	For Commercial Kitchens (not for residential use)		

# MEGA TOP SANDWICH PREP TABLE REFRIGERATORS

## TECHNICAL DATA



Model Numbers		ASP60M	ASP72M
<b>Dimensions &amp; Construction</b>	Interior Capacity (cu/ft)	17.8	22.3
	GN Pans	24, Clear Plastic	30, Clear Plastic
	Exterior Size WxDxH (inches)	61 1/4 x 37 1/4 x 47 7/8	72 x 37 1/4 x 47 7/8
	Interior Size WxDxH (inches)	57 x 25 3/8 x 28 3/4	67 3/4 x 25 3/8 x 28 3/4
	Exterior Construction	High polished stainless steel	
	Interior Construction	Stainless steel	
	Cutting Board WxDxH (inches)	61 1/4 x 9 1/2 x 1, NSF certified polyethylene white plastic	72 x 9 1/2 x 1, NSF certified polyethylene white plastic
	Shelves	2 white epoxy coated wire	3 white epoxy coated wire
	Handle	ABS Plastic, recessed	
	Solid Door	2 Stainless Steel Doors	
	Door Gasket	Tongue and groove, easy to clean & replace	
	Hinges	Stainless steel	
	Pilasters and Shelf Clips	Stainless steel	
	Floor	Rounded, coved corners	
Casters	(2) Locking, (2) non-locking	(2) Locking, (2) non-locking	
<b>Refrigeration System</b>	Temperature Range	33°F to 41°F	33°F to 41°F
	Refrigeration System	Forced Air	
	Refrigerant	R292	R293
	Expansion Device	Capillary Tube	
	Defrost method	Automatic	
	Compressor Type	Hermetic compressor	
	Condenser Type	Air cooled, electrostatic coated copper tube	
	Evaporator Type	Air cooled, electrostatic coated copper tube	
<b>Electrical System</b>	Humidity control	Hot gas condensation evaporation	
	Power	115/60/1	115/60/1
	Plug	8 Ft NEMA 5-15P	8 Ft NEMA 5-15P
	Horse Power	1/5	1/5
	Kilowatts per 24 Hours	3.9	4.0
<b>Packaging &amp; Shipping Info</b>	Shipping Dimensions		
	Shipping Weight		
	Palletized	Yes, wood, front/back loading	
	Material	Wood, card board, styrofoam, plastic wrap	
<b>Digital Temperature Controller</b>	UPC GTIN		
	Digital Temperature Microprocessor	Precision temperature pre-set to 33°F to 41°F. Adjustable set-point, temperature differential, evaporator fan on/off cycles & air defrost cycles.	
	Key Pad	Adjustable, tactile key pad	
	Screen	2" blue LCD	2" blue LCD
<b>Warranty</b>	Water resistant	Yes	Yes
	Compressor	5 Years	5 Years
	Parts	2 Years	2 Years
<b>Certifications</b>	Labor	2 Year	2 Year
		ETL sanitation (conforms to NSF 7 Foodservice), ETL electrical (US and Canada)	
<b>Application</b>	For Commercial Kitchens (not for residential use)		

# MEGA TOP SANDWICH PREP TABLE REFRIGERATORS

## TECHNICAL DATA



Model Numbers		ASP29M-SI	ASP48M-SI
<b>Dimensions &amp; Construction</b>	Interior Capacity (cu/ft)	6.7	13.8
	GN Pans	12, Clear Plastic	18, Clear Plastic
	Exterior Size WxDxH (inches)	29 x37 1/4x47 7/8	48 3/8 x 37 1/4x47 7/8
	Interior Size WxDxH (inches)	24 3/4 x 25 3/8 x 28 3/4	44 1/4 x 25 3/8 x 28 3/4
	Exterior Construction	High polished stainless steel	
	Interior Construction	Stainless steel	
	Cutting Board WxDxH (inches)	29 x 9 1/2 x 1, NSF certified polyethylene white plastic	48 3/8 x 9 1/2 x 1, NSF certified polyethylene white plastic
	Shelves	1 white epoxy coated wire	2 white epoxy coated wire
	Handle	ABS Plastic, recessed	
	Solid Door	1 Stainless Steel Door	2 Stainless Steel Doors
	Door Gasket	Tongue and groove, easy to clean & replace	
	Hinges	Stainless steel	
	Pilasters and Shelf Clips	Stainless steel	
	<b>Refrigeration System</b>	Floor	Rounded, coved corners
Casters		(2) Locking, (2) non-locking	
Temperature Range		33°F to 41°F	33°F to 41°F
Refrigeration System		Forced Air	
Refrigerant		R290	R291
Expansion Device		Capillary Tube	
Defrost method		Automatic	
Compressor Type		Hermetic compressor	
<b>Electrical System</b>	Condenser Type	Air cooled, electrostatic coated copper tube	
	Evaporator Type	Air cooled, electrostatic coated copper tube	
	Humidity control	Hot gas condensation evaporation	
	Power	115/60/1	115/60/1
	Plug	8 Ft NEMA 5-15P	8 Ft NEMA 5-15P
<b>Packaging &amp; Shipping Info</b>	Horse Power	1/6	1/5
	Kilowatts per 24 Hours		
	Amperage	2.8	3.9
	Shipping Dimensions		
	Shipping Weight		
<b>Digital Temperature Controller</b>	Palletized	Yes, wood, front/back loading	
	Material	Wood, card board, styrofoam, plastic wrap	
	UPC GTIN		
	Digital Temperature Microprocessor	Precision temperature pre-set to 33°F to 41°F. Adjustable set-point, temperature differential, evaporator fan on/off cycles & air defrost cycles.	
	Key Pad	Adjustable, tactile key pad	
<b>Warranty</b>	Screen	2" blue LCD	2" blue LCD
	Water resistant	Yes	Yes
	Compressor	5 Years	5 Years
<b>Certifications</b>	Parts	2 Years	2 Years
	Labor	2 Year	2 Year
<b>Application</b>	ETL sanitation (conforms to NSF 7 Foodservice), ETL electrical (US and Canada)		
	For Commercial Kitchens (not for residential use)		

# SANDWICH PREP TABLE REFRIGERATORS

## TECHNICAL DATA



Model Numbers	ASP60M-SI	ASP72M-SI	
<b>Dimensions &amp; Construction</b>	Interior Capacity (cu/ft)	17.8	22.3
	GN Pans	24, Clear Plastic	30, Clear Plastic
	Exterior Size WxDxH (inches)	61 1/4 x 37 1/4 x 47 7/8	72 x 37 1/4 x 47 7/8
	Interior Size WxDxH (inches)	57 x 25 3/8 x 28 3/4	67 3/4 x 25 3/8 x 28 3/4
	Exterior Construction	High polished stainless steel	
	Interior Construction	Stainless steel	
	Cutting Board WxDxH (inches)	61 1/4 x 9 1/2 x 1, NSF certified polyethylene white plastic	72 x 9 1/2 x 1, NSF certified polyethylene white plastic
	Shelves	2 white epoxy coated wire	3 white epoxy coated wire
	Handle	ABS Plastic, recessed	
	Solid Door	2 Stainless Steel Doors	
	Door Gasket	Tongue and groove, easy to clean & replace	
	Hinges	Stainless steel	
	Pilasters and Shelf Clips	Stainless steel	
	Floor	Rounded, coved corners	
	Casters	(2) Locking, (2) non-locking	(2) Locking, (2) non-locking
<b>Refrigeration System</b>	Temperature Range	33°F to 41°F	33°F to 41°F
	Refrigeration System	Forced Air	
	Refrigerant	R292	R293
	Expansion Device	Capillary Tube	
	Defrost method	Automatic	
	Compressor Type	Hermetic compressor	
	Condenser Type	Air cooled, electrostatic coated copper tube	
	Evaporator Type	Air cooled, electrostatic coated copper tube	
<b>Electrical System</b>	Humidity control	Hot gas condensation evaporation	
	Power	115/60/1	115/60/1
	Plug	8 Ft NEMA 5-15P	8 Ft NEMA 5-15P
	Horse Power	1/5	1/5
	Kilowatts per 24 Hours	3.9	4.0
<b>Packaging &amp; Shipping Info</b>	Amperage	3.9	4.0
	Shipping Dimensions		
	Shipping Weight		
	Palletized	Yes, wood, front/back loading	
	Material	Wood, card board, styrofoam, plastic wrap	
<b>Digital Temperature Controller</b>	UPC GTIN		
	Digital Temperature Microprocessor	Precision temperature pre-set to 33°F to 41°F. Adjustable set-point, temperature differential, evaporator fan on/off cycles & air defrost cycles.	
	Key Pad	Adjustable, tactile key pad	
	Screen	2" blue LCD	2" blue LCD
<b>Warranty</b>	Water resistant	Yes	Yes
	Compressor	5 Years	5 Years
	Parts	2 Years	2 Years
<b>Certifications</b>	Labor	2 Year	2 Year
		ETL sanitation (conforms to NSF 7 Foodservice), ETL electrical (US and Canada)	
<b>Application</b>	For Commercial Kitchens (not for residential use)		



## **CONTACT US:**

### **Customer Service**

+1(786) 5847439

Sales team:

+1(786) 8602528

WEB SITE:

**[www.ifsusa.store](http://www.ifsusa.store)**

Email:

[sales@ifsusa.store](mailto:sales@ifsusa.store)